



Instruction Manual for Rear-fender-less Tail Lamp Kit for KAWASAKI's D-Tracker

Item No. : 09 - 03 - 1941 (LED slim tail / Red lens)
 : 09 - 03 - 1942 (LED slim tail / Clear lens)

Applicable models and frame Nos

KAWASAKI's 2004 and subsequent D-TRACKER models
LX250E-A04311 ~

- Thank you for purchasing one of our TAKEGAWA's products. Please strictly follow the following instructions in installing and using the products.
- Before fitting the products, please be sure to check the contents of the kit. Should you have any questions about the products, please kindly contact your dealer.

Please note that, in some cases, the illustrations and photos may vary from the actual hardware.

~ Features ~

This is the rear-fender-less kit with which a normal rear winker can be utilized as it is.
With an LED slim tail lamp equipped, you can get a clear rear view.

Please read following instructions before installation

We do not take any responsibility for any accident or damage whatsoever arising from the use of the products not in conformity with the instructions in the manual.

We shall be held free from any kind of warranty whatsoever of products other than this product if the glitch takes place on the other products than this one after the installation and use of this product.

This product is designed for exclusive use in the above-mentioned types of motorcycles and frame numbers only. Please take note that this product cannot be mounted on other types of motorcycles.

Before installation, please refer to genuine parts service manual for your vehicle in order to work correctly.

Prepare right tools for the work, and work carefully following the installation procedures. In addition, this instruction manual as well as Kawasaki's service manual is prepared with those in mind who have basic technical skills and knowledge. So, it is advisable that those who do not have such tools, or skills or knowledge contact a technically reliable specialist shop for installation.

Please be informed in advance that we are not in a position to guarantee against any damage or breakage of parts caused by driving on an unusually bad or rough road.

In case any alteration is made to the product outside our factory, we shall be held free from any guarantee of the product.

You are kindly requested not to contact us about the combination of our products with other manufacturers'.

Some of the bolts, nuts, and rubber packings will be reused. However, be sure to replace worn-down or severely-damaged ones with new ones.

Please use either a stock winker or our TAKEGAWA's aero winker (Item Nos: 09-03-196 / 09-03-197).



CAUTION

The following show the envisioned possibility of injuries to human bodies as a result of disregarding the following cautions.

- Always try to drive your motorcycle at a legal speed, abiding by the laws.
- Work only when the engine and the muffler are cool. (Otherwise, you will burn yourself.)
- Prepare right tools for the work, and do the work in the proper and right way.
(Otherwise, improper work could cause breakage of parts or injuries to yourself.)
- Always use a torque wrench to screw bolts and nuts tight and securely to the specified torque.
(Improper torque could cause these parts to get damaged or fall off.)
- As some products and frames have sharp-pointed or protruding portions, please work with your hands protected.
(Otherwise, you will suffer injuries.)
- Before riding, always check every section for slack in parts like screws. If you find slack ones, screw them securely up to the specified torque.
(Or improper torque may cause parts to come off.)
- Check carefully bolts and nuts to be reused, and in case wear or damage is detected, always replace them with new ones.



WARNING

The following show the envisioned possibility of human death or serious injuries to human bodies as a result of disregarding the following cautions.

- When you notice something abnormal with your motorcycle while riding down a road, stop riding immediately and park your motorcycle in a safe place. (Otherwise, the abnormality could lead to an accident.)
- Before doing work, place the motorcycle on level ground to stabilize the position of your motorcycle for safety's sake.
(Otherwise, your motorcycle could fall down and injure you while you are working.)
- Check or perform maintenance of parts correctly according to the procedures in the instruction manual or a service manual.
(Improper checking or maintenance could lead to an accident.)
- If you find damaged parts when checking and performing maintenance, do not use these parts any longer, and replace them with new ones.
The continued use of these damaged parts as they are could lead to an accident.)
- Keep plastic bags for packing products away from babies and children to avoid danger of suffocation, or discard them.

Please be informed that, mainly because of improvement in performance, design changes, and cost increase, the product specifications and prices are subject to change without prior notice.

This manual should be retained for future reference.

~ Kit Contents ~



No.	Parts Names	Qty	Repair Part No.	Qty
1	Light stay	1	21689-LX2-T00	1
2	License plate stay	1	21688-LX2-T00	1
3	LED slim tail lamp	1	09-03-1900	1
4	Sub-harness	1	33705-LX2-T00	1
5	Washers, 6mm	2	BW-01-0045	5
6	Socket cap screws, 6 x 35	2	BW-00-0066	4

Please order repair parts by indicating the Repair Part Item No. as listed above. As you see from the list, depending on the repair parts, in some cases we may not be in a position to accept your order for a single item in the quantity of one. In this case, please order the required parts as a set part unit, quoting the Repair Part Item No. described in the right-side column in the above list.

~ Installation Procedures ~

Before Installation

- 1 . Stabilize your vehicle with a maintenance stand or the like on level ground.
- 2 . Start the work only after you have checked that the ignition switch is turned OFF.

Genuine Rear Fender Removal

- 1 . Detach a license plate (or, a number plate).
- 2 . Unfasten both right and left side cover bolts, and dismantle a seat by pulling it backwards .

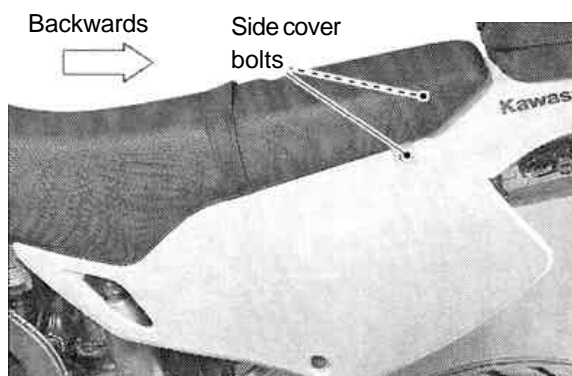

- 3 . Disconnect 3 pieces of connectors for the tail and brake lamps.
- 4 . Unfasten four screws fixing the rear fender, and pull the harness of the genuine tail lamp out of the tail cowl. Then remove the rear fender from the body.
Keep these removed 4 screws for installing this Kit with. And in case they are severely damaged, replace them with new ones.

- 5 . Take four collars and rubbers from the removed rear fender, and keep them for fixing the kit later. If they have severe damages, replace them with the new ones.



Assembly of Fender-Less Tail Lamp Stay

- 1 . To the stay in the kit, attach the four rubbers which you have just detached. And put in the collar you just took off. Be careful not to fix the stay inside out. See the figure below.
(By moving the rubber mounting location back and forth, the tail lamp location can be adjusted backwards or forwards.)
- 2 . Unfasten all the nuts on the LED slim tail lamp. Being careful about which side is up and down, install the said tail lamp to the light stay firmly with the unfastened nuts.

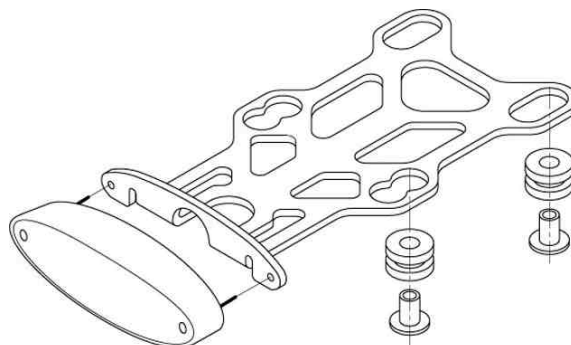

Wiring of the Tail Lamp

- 1 . Connect the sub-harness 3-p connector to the one on the tail / brake lamp on the genuine main harness. (Located under the seat)



- 2 . Pass the sub-harness with a plug at the tip to the place where a genuine harness on the tail cowl was installed.
 - 3 . Connect the plug of the just-assembled LED slim tail lamp wiring to the plug on the sub-harness.
- △NOTE : Be careful about the colors of the wires. Connect the wires of a color.

	LED Tail lamp
Brake Lamp	Red
Small Lamp	Black
GND	Yellow

- 4 . After connecting the plugs, wind a vinyl tape on the plug cover to protect it from water.
- 5 . As shown in the photo below, secure the wires with a hook, on the frame to the right of the rear tail cowl, used for holding the harness.



Adjustment and Fixation of Stay

- 1 . Attach the assembled light stay to the vehicle for now.
Be careful not to jam the wires of LED slim tail lamp and sub-harness between the stay and the vehicle. Pass the two shorter screws, which were holding the genuine fender, through the collars at the front part of the light stay to fix the stay to the vehicle. And tighten the screws lightly for now.

- 2 . Fit the 6mm washer into the supplied 6x35 socket cap screw, and pass them through the elongated hole on the license plate stay. Then put them through the collar on the rear side of the light stay, and hold the screw loosely for now.

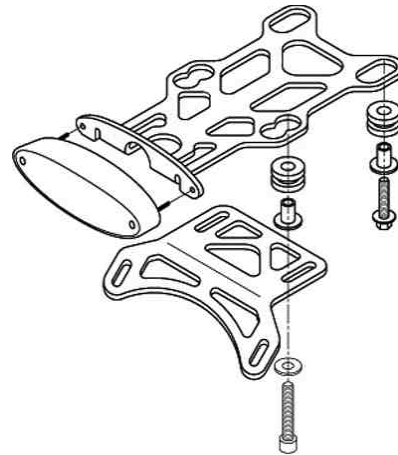

- 3 . Temporarily attach the license plate to kit's license plate stay.
△NOTE : Onto the license plate stay, never install anything other than the license plate or our Reflector Kit. Otherwise, the stay may get damaged because of the increased weight or vibration.
- 4 . Turn ON the ignition switch to light the license plate lamp on the tail lamp.
Adjust the position of the plate so that the license plate lamp may light the entire license plate to be recognizable at night, and then attach the license plate after setting the plate location.
△NOTE : Please keep the ignition switch turned on down to a minimum. Keeping it ON for a long time may cause battery to get flat.
- 5 . Tighten the four screws which are fixing the stay.
Torque: 5.9 ~ 7.8N·m (0.6 ~ 0.8 kgf·m)
- 6 . Tighten the two screws which are fixing the license plate.
- 7 . Fit in the seat hooks to the stoppers on the fuel tank and frame. And reinstall the seat in its original position, and tighten the side cover bolt.

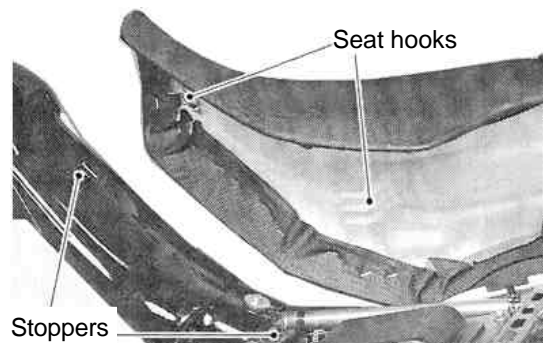

Final Confirmation

- 1 . Start the engine in a well-ventilated place, and check that the tail lamp works properly.
If it does not work well, there is a possibility of a bad fit of wiring or short circuit, which please recheck.
- 2 . Please check whether or not the exhaust from the muffler is blowing into the license plate, by snapping the throttle slightly and putting a hand over the rear side of the license plate.
△NOTE : Blowing of the exhaust into the license plate causes the license plate to vibrate or to resonate, leading to the stay breakage.

SPECIAL PARTS TAKEGAWA Co.,Ltd.

3-5-16 Nishikiorihigashi Tondabayashi Osaka Japan

TEL : 81-721-25-1357 FAX : 81-721-24-5059

URL : <http://www.takegawa.co.jp>